



SPECIAL
ECONOMIC
ZONE

DEVELOPED
BY GDP QUADRAT

STUPINO
QUADRAT

THE DRIVER OF RUSSIA'S INDUSTRIALIZATION

making investments happen by making investors happy©



OUR APPROACH



The investor concentrates
only on production and sales

We take care of the rest

LOCATION



Proximity to Moscow, Labor resources

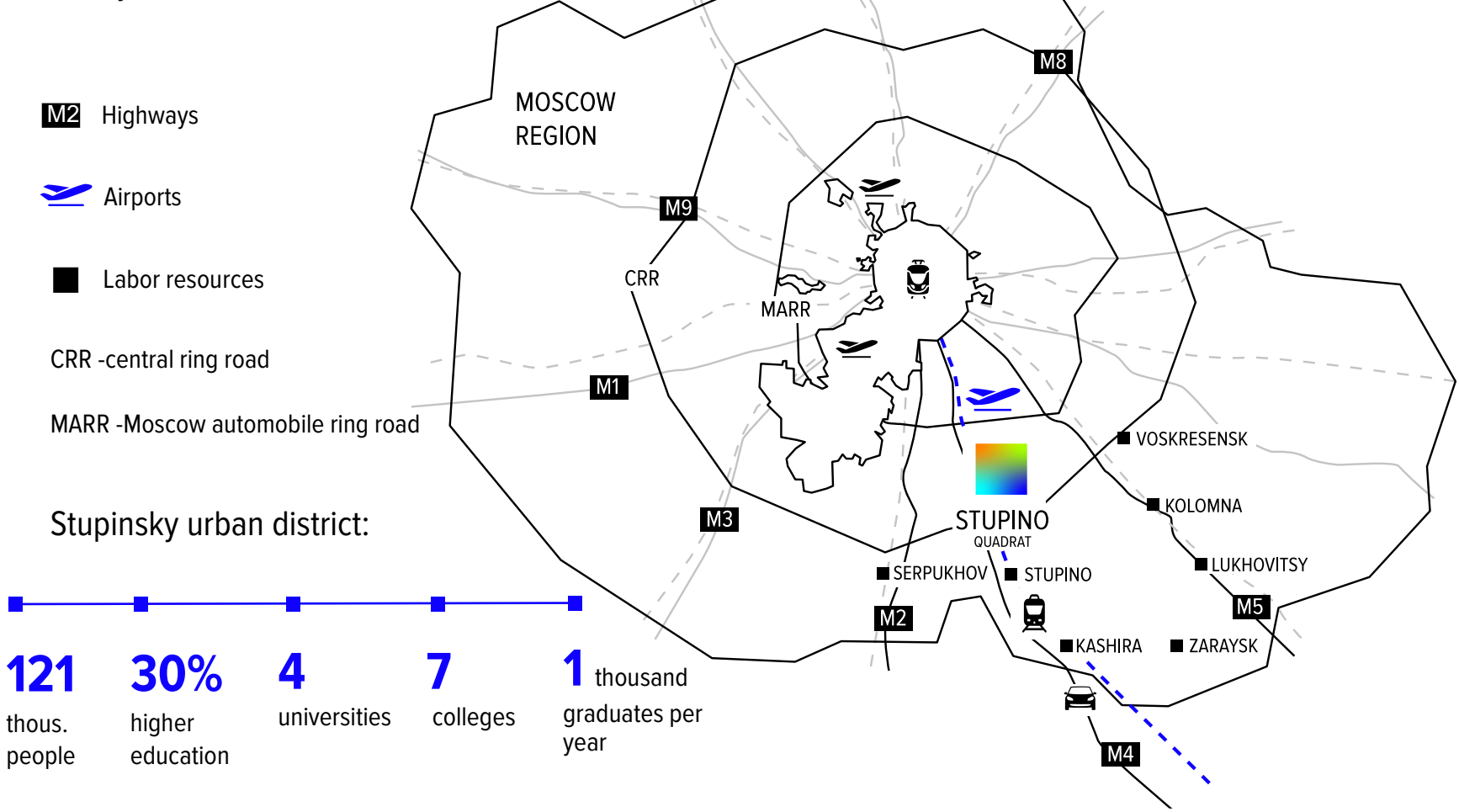

Access to major transportation and logistics hubs in Russia

LOCATION

Transport accessibility

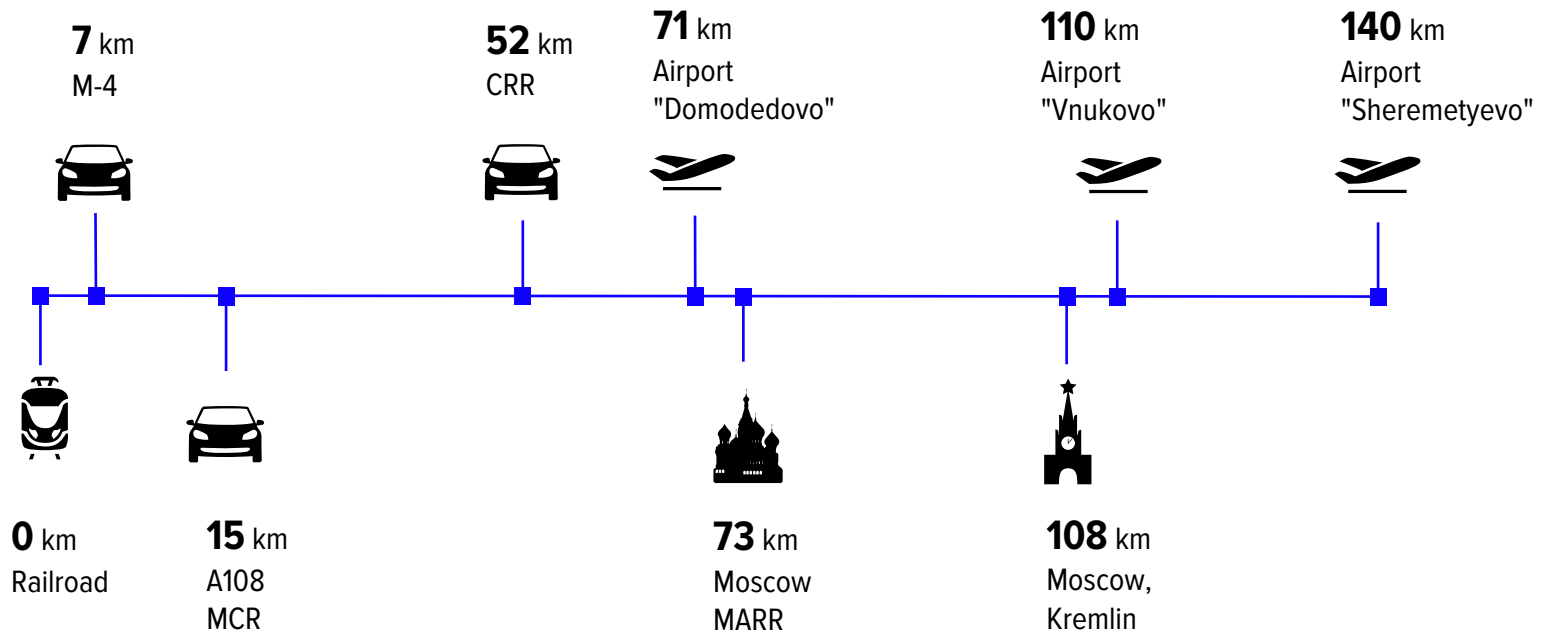

Moscow and Moscow region **25** mln people

PREFERENCES AND BENEFITS OF SEZ

Profit	Property	Land	Transport
Stupino quadrat	Stupino quadrat	Stupino quadrat	Stupino quadrat
2% first 8 years 7% next 6 years 15,5% by 2064	0% 10 years after registration of the property	0% 5 years after registration of the property right	0% years after registration of the transport vehicle
The rest of Russia 20%	The rest of Russia until 2,2%	The rest of Russia until 1,5%	The rest of Russia until 15%

Import of manufacturing lines & raw materials

Vat & customs duties excluded

Guarantee of unchanged rules for 10 years and protection from unplanned inspections

READY-MADE INFRASTRUCTURE



55 000 m³
of gas



100 MW
electricity



1 Gbit
fiber optics



water intake point,
sewage treatment
facilities **15 000** m³



Railway
station



INDUSTRIAL INFRASTRUCTURE

⚡ Electricity: : **100** MW

🔥 Gas: **55 000** m³/h

👤 Labor resource

💧 Water supply: **15 000** m³/day

○ Wastewater treatment facilities (storm water)

● Wastewater treatment facilities (sewerage)

🚂 Railway station on the territory

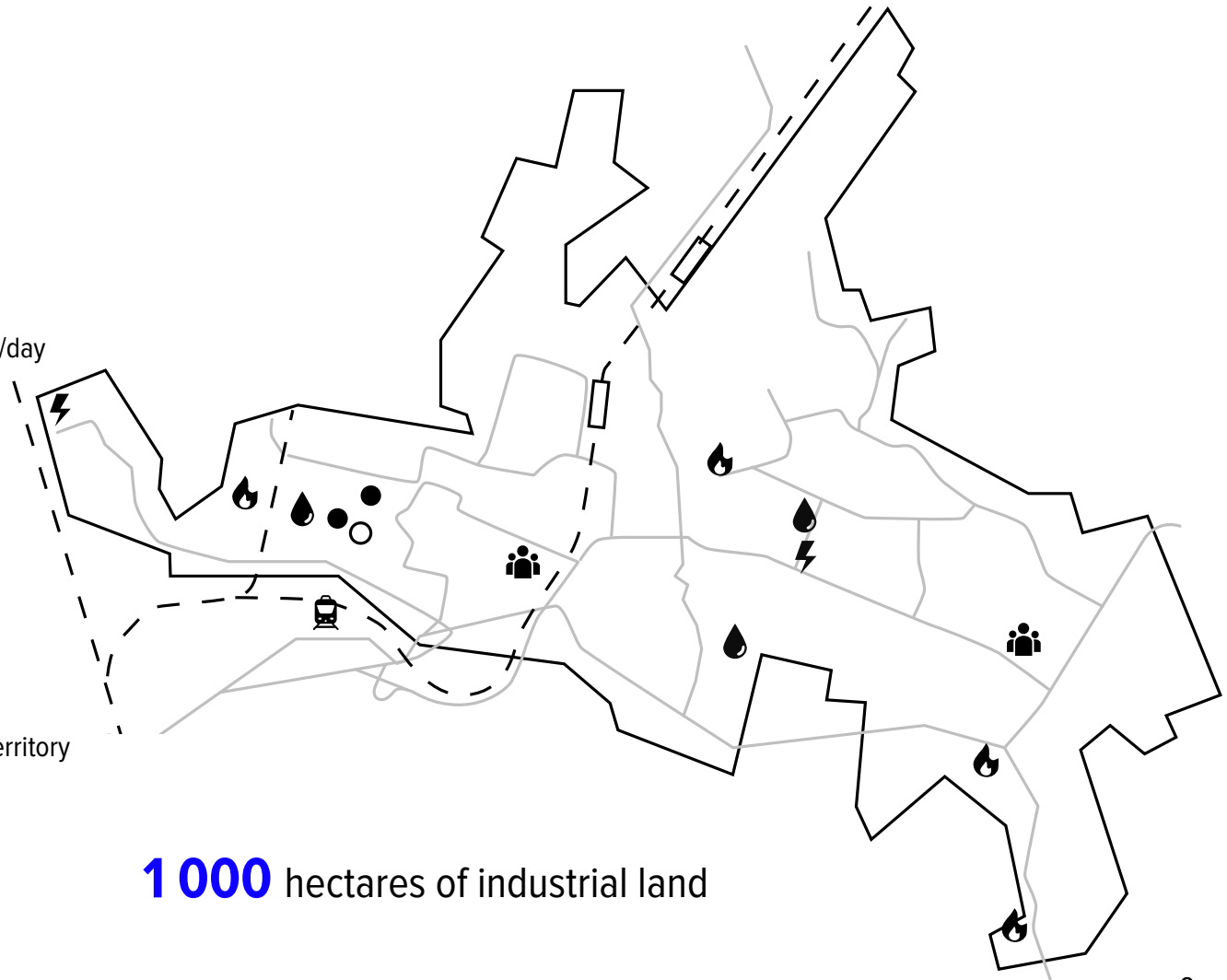

1 000 hectares of industrial land



PREFERENTIAL FINANCING



- Support for SMEs
- Industrial Development Fund
- Export support by the Russian Export Center
- Preferential financing banking programs
- Federal/regional support measures
- Project financing

SEZ STUPINO QUADRAT OFFICE AND K-HOTEL GDP QUADRAT



Aparthotel for **16** rooms

Office SEZ Stupino Quadrat
Kovorking
Meeting rooms



BARILLA

The largest producer of pasta in the world. Plants in Italy, Greece, France, Germany, Norway, Sweden, Turkey and the USA

- 35% US market
- 45% Italian market
- Revenue 3,4 billion €
- Workplaces 300 people
- Investments 95 million € until 2024 r.
- 1,1 billion € capitalization of the company



UFLEX



World leader in food film production Revolutionary technology: plastic film completely degrades after 90 days of contact with soil

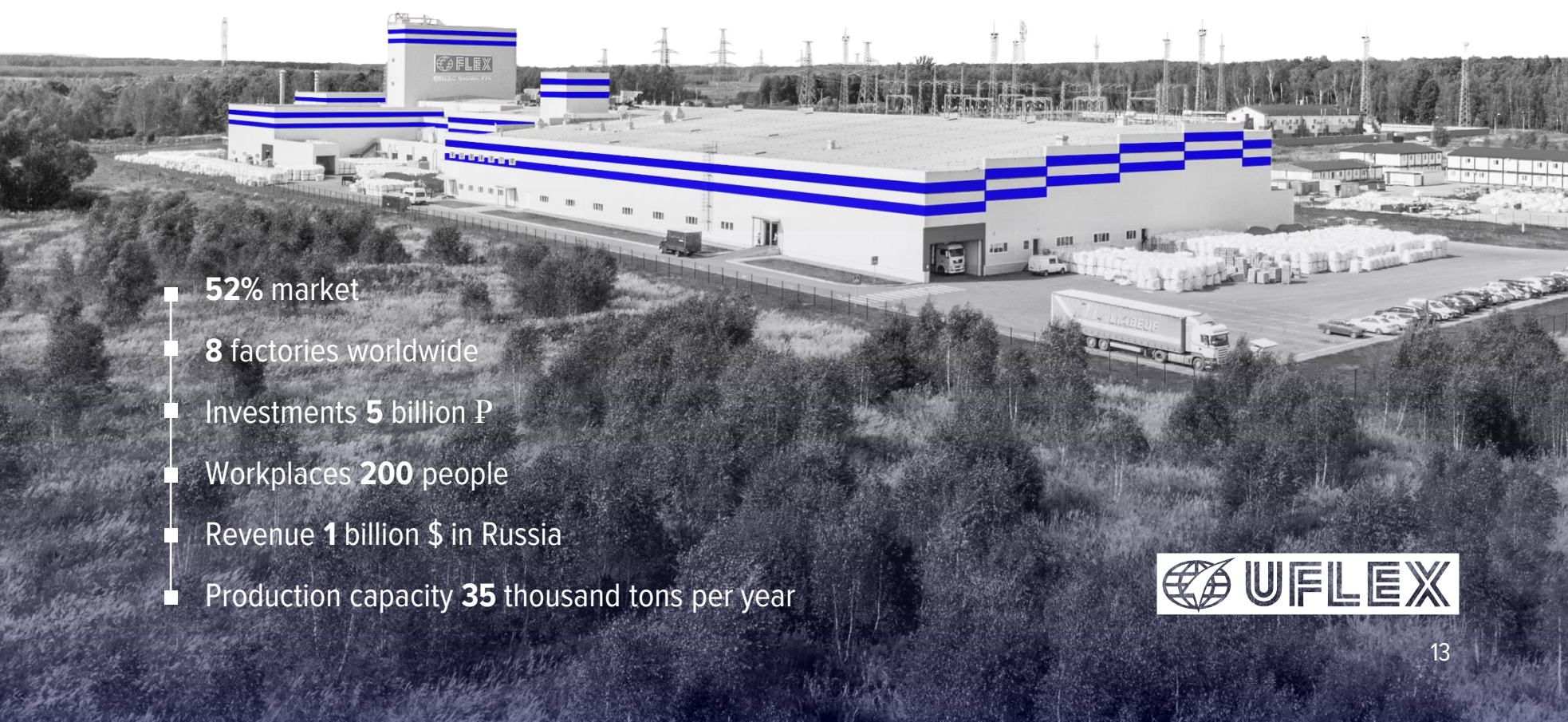

- 52% market
- 8 factories worldwide
- Investments 5 billion P
- Workplaces 200 people
- Revenue 1 billion \$ in Russia
- Production capacity 35 thousand tons per year



MISSION FOODS STUPINO



Global concern GRUMA CORPORATION – manufacturer of tortillas and corn flour products



STUPINO ELECTROTECHNICAL PLANT



A subsidiary of a German electrotechnical concern Production in China, Germany, India, Poland, Russia, Sweden, Switzerland, Turkey, USA, Taiwan

- 2,5 billion € turnover
- 17,6 thousand employees
- Investments 633 mln ₺
- More than 50 products
- Electrical and automation products and solutions



MONIN

MONIN the world's leading producer of syrups and fruit and berry fillers

- 104 mln € assets
- Workplaces 54 people
- Investments 1,3 billion P
- Factories in France, USA, India, China, Malaysia, Brazil

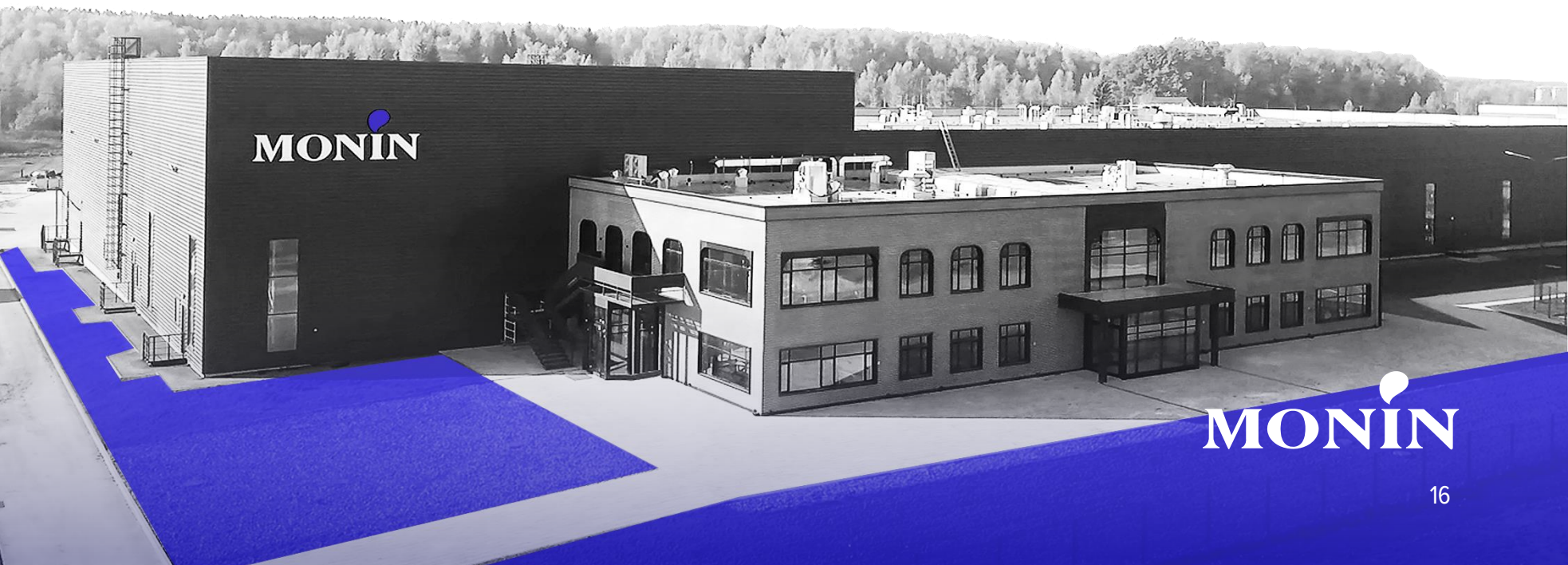

MONIN

ARVALUS

Austrian family business "bakers for bakers". Official partner of the Russian Ice Hockey Federation

- More than 600 types of ingredients for bakery and confectionery production
- Sales in 100 countries
- Investments 760 mln P
- Workplaces 47 people
- 14 factories



backaldrin®

ARVALUS

MUSTANG STUPINO

Russia's leading manufacturer of pet food

- Investments **1,7** billion ₺
- Workplaces **70** people

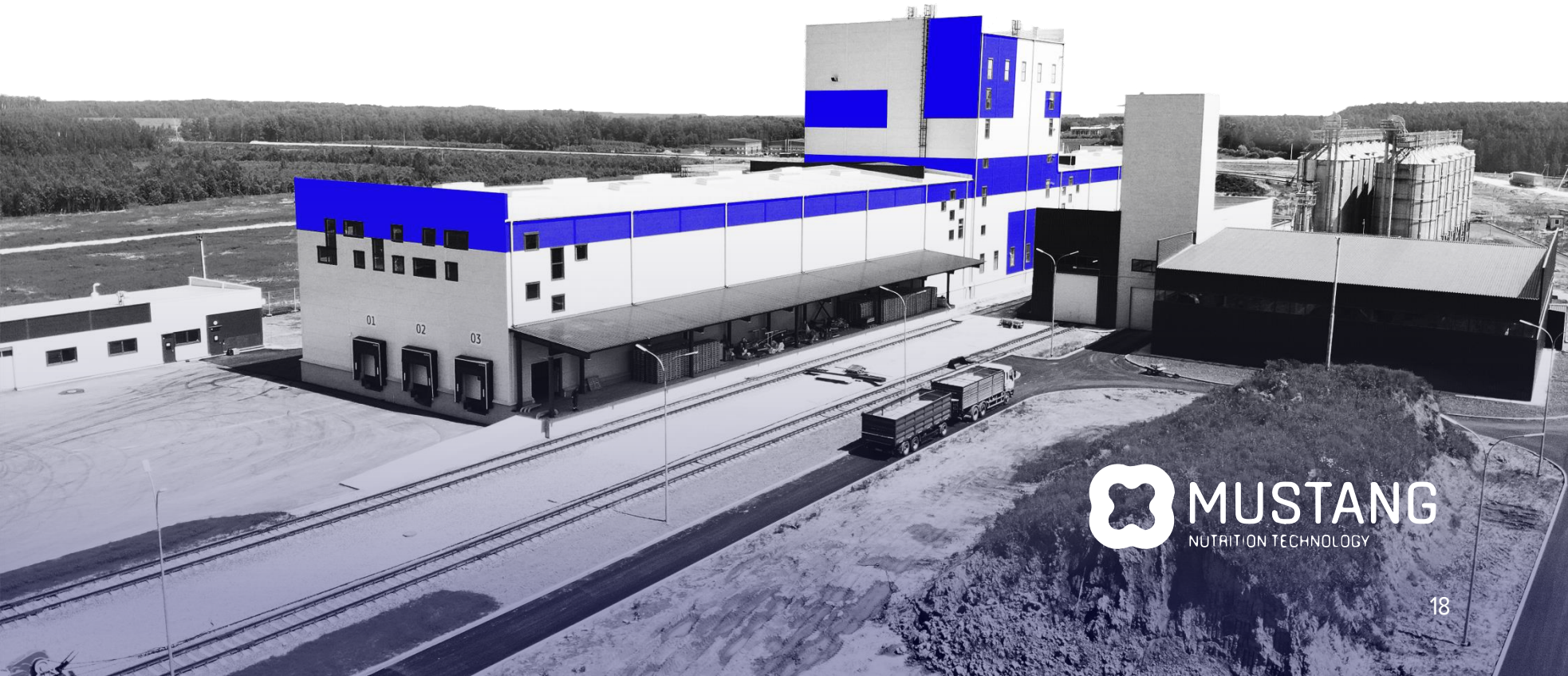

Di TEX

The first Russian enterprise with digital fabric printing technology

- Investments **1 billion P**
- Workplaces **150** people

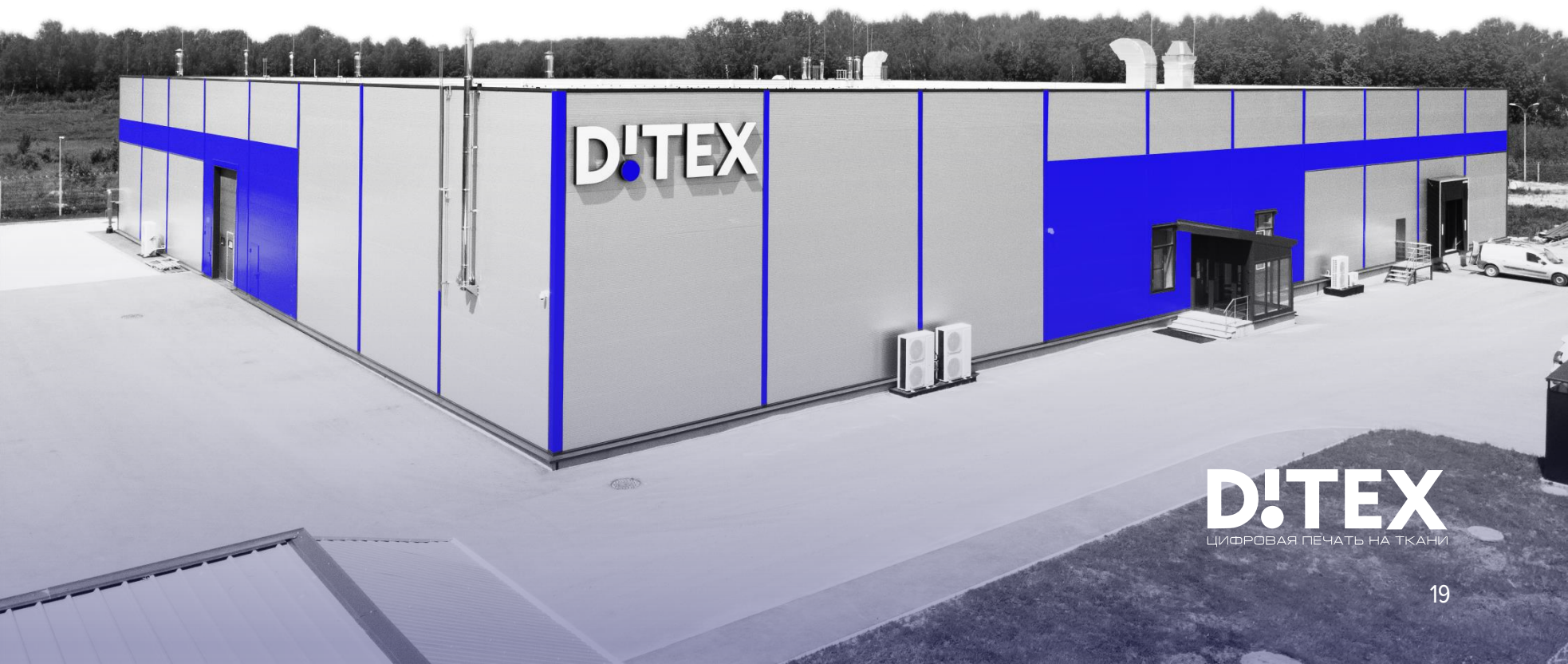

D!TEX
ЦИФРОВАЯ ПЕЧАТЬ НА ТКАНИ

CATALYST SYSTEM SERVICE

The newest enterprise for the regeneration and reactivation of catalysts for oil refineries.
Import Substitution project

- Investments 1,2 billion P
- Workplaces 60 people



KRASKO

Russian manufacturer of a wide range of high quality paintwork materials and polymer coatings for the protection of metal, concrete, wood

- Investments **350** billion P
- Workplaces **70** people



INTEL BIO

Scientific development, production, distribution of drugs for treatment and prevention of skin diseases

- Investments 150 mln ₺
- Workplaces 30 people



FENIKS CHIMNEYS

The company specializes in the production of stainless steel chimneys for domestic and industrial use

- Investments 60 mln ₺
- Workplaces 30 people

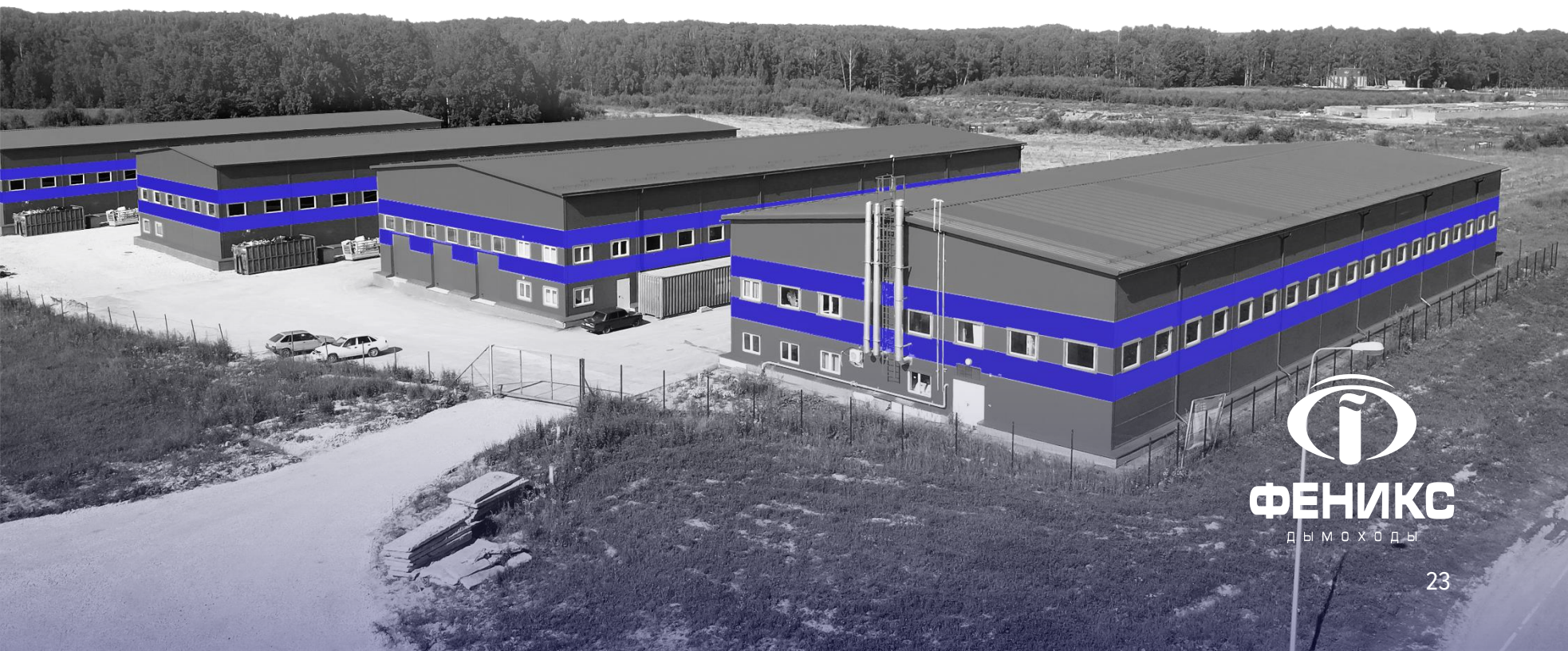

FROZEN BAKE

Manufacturer of frozen bakery products

- Investments 600 billion P
- Workplaces 91 people



Putting into operation

Frozen Bake

DEKAST-M

Manufacturer of innovative and energy efficient water and heat meters

- Investments 60 billion P
- Workplaces 60 people



DECAST

SOCIAL INFRASTRUCTURE

New Stupino - a comfortable and safe place to live for employees and their families

3 km from Stupino Quadrat, **12** thousands of people

School

Sport

Housing

Stores

Kindergarten



Hotel (5 km)

INDUSTRIAL TOURISM

Showing industries and factories for schoolchildren, students, tourists and professionals

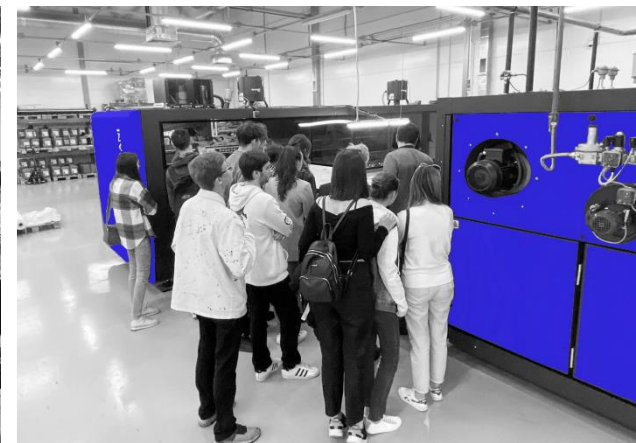

IMPROVE THE TERRITORY

Building a cultural leisure zone



Holding festivals

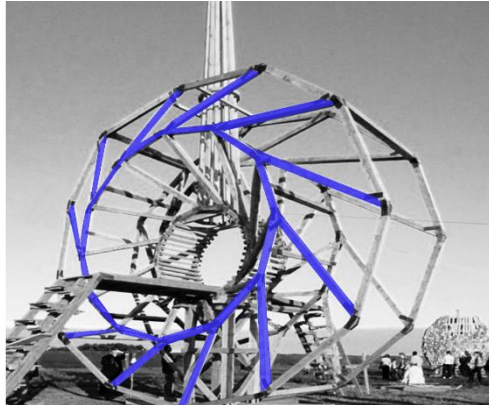

Designing the motorcycle track

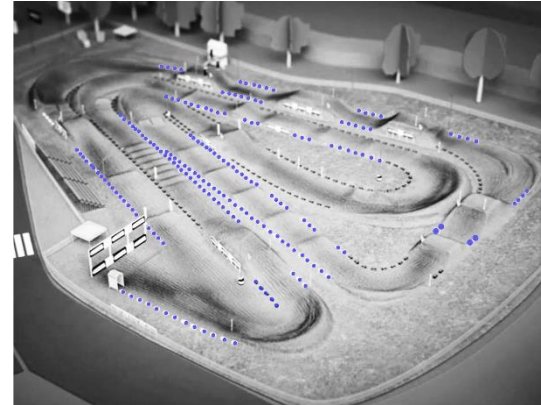

Philharmonic



Building an organic farm



Developing an art space



Designing the ski slope

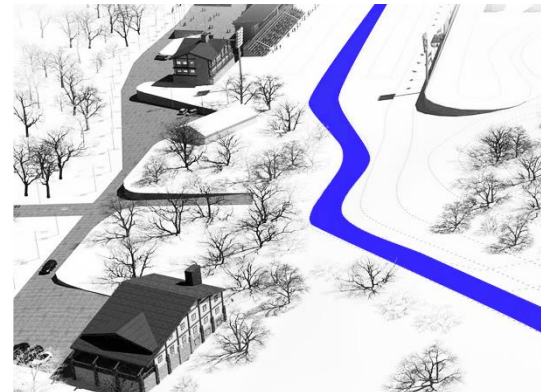

University



HOW TO BECOME A RESIDENT IN THE SEZ?

- Establish or relocate your company in the Stupino Urban District
- Make a business plan
 - Investments of at least 120 mln ₽, of which 40 mln ₽ in the first 3 years
- Decision of the expert commission of the Ministry of the Moscow region
- Agreement with the Russian Federation, the investor and the SEZ management company
 - The grace period begins from the moment the agreement is signed

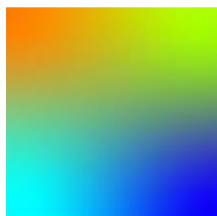

SPECIAL
ECONOMIC
ZONE

DEVELOPED
BY **GDP QUADRAT**

STUPINO QUADRAT

Office in Stupino

142821, Russia, Stupino, Moscow region,
Shmatovo village, Industrial street, v.4, p.1.

Moscow office

117105, Russia, Moscow, Moscow, Varshavskoe
shosse, 1, p. 1. BC "W Plaza-1", office B110

Phone: +7 495 280 14 42

Fax: +7 495 280 14 43

hotline@gdpquadrat.com

www.gdpquadrat.com

making investments happen by making investors happy©